

SUPPORTING RESIDENCES FOR STUDENTS OF HOSEI UNIVERSITY

2020



PARTNERSHIP WITH
KYORITSU MAINTENANCE CO., LTD.



About our student dormitories

1. Daily Meals

• Each dormitory has a kitchen, and homemade breakfast and supper are provided everyday (Except Sundays, National Holidays, the 5th Saturday, Summer Holiday and Winter Holiday) to support health of busy student's. You can save time for cooking and washing dishes. You will enjoy fresh meals using your time effectively! You can choose Japanese or Western menu for breakfast.

※ Last order time for breakfast is 15minutes before the closing time, and that for dinner is 30minutes before the closing time.

※ **Attention: It's not possible to respond to your personal requests according to your allergy or religious restriction. Vegetarian / religious menu such as halal are not available.**



2. Facilities & Equipment

. Students do not need to buy or bring their own furniture because necessary fixtures and furniture for daily life are provided, which saves you the cost of moving. Each room is furnished with a bed, desk, chair, air-conditioner, IP telephone, bookshelf, closet or chest, and lamp. Each room has 24 hour dedicated Internet connection. Also, IP telephone in each room will help you to save the phone bill.

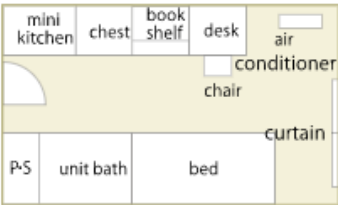

3. Common Facilities

• Our dorm has many common facilities. You can use not only the dining room, kitchen, big bath, laundry room and private shower room but also the electric appliances such as a vacuum cleaner and an iron.

※ Actual equipment may differ from the images.

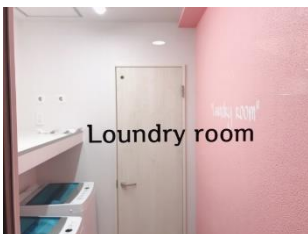

4. Safety Management

• A dormitory manager helps residents with their daily life, and cares about their health condition and security. When you're sick, or when a package for you needs to be received while you are absent , they will support you.



We hope our dormitory would be a place that gives many opportunities to interact with other languages and cultures in your daily life.

Dormitories for student of Hosei University

Hosei University Komagome Dormitory (For Women & Men)

市ヶ谷 ICHIGAYA Campus

Hosei University Komagome Dormitory

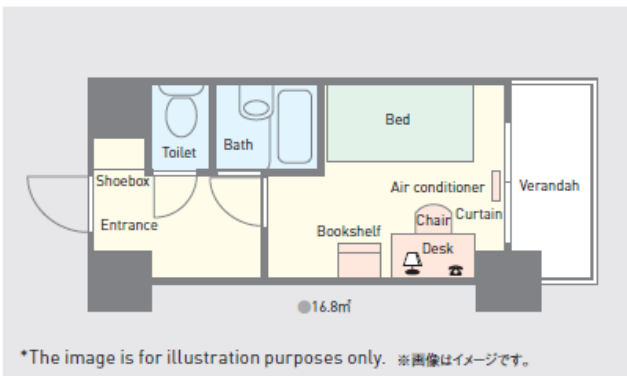

Access: Approximately 5 minutes walk from “Komagome” Station of Tokyo metoro nanboku Line
Address: 3-16-19, Komagome, Toshima-ku, Tokyo, 170-0003
Room size: 16.80m² / **Capacity :** 102people

Dorm Hours

Curfew: No Curfew
Breakfast: 6:30AM ~ 8:30AM
Dinner: 6:30PM ~ 11:30PM
Public Bath: 6:30PM ~ 0:00
Private shower: 24hrs available

Access to Ichigaya campus

Komagome Sta.⇒ Iidabashi Sta. ¥165
(8min. by Express of Toei Shinjuku Line)

APPLICATION FEE (One Time)	Security Deposit	50,000 yen
	Entrance Fee	150,000 yen (1year) 200,000yen (2years) 260,000yen (3years) 280,000yen (4years)
	Annual Maintenance Fee	222,000yen
	Building Maintenance Fee	3,000yen/year
	Room Cleaning Fee	46,440yen
TOTAL OF APPLICATION FEE		459,440 ~ 589,440yen
MONTHLY FEE	Rent	100,100 yen with meals 83,000yen without meals
	Internet Facility Fee	3,888yen
	Electricity Fee	Basic 780yen+ Usage x Tax 8%
TOTAL OF MONTHLY FEE		87,668 or 104,768yen~

■Dormitories for student of Hosei University

Hosei University Funabori Dormitory (For Women & Men)

市ヶ谷 ICHIGAYA Campus



Access: Approximately 5 minutes walk from "Funabori" Station of Toei Shinjuku Line

Address: 1-4-7, Funabori, Edogawa-ku, Tokyo, 134-0091

Room size: 16.20m² / **Capacity:** 89 people

Dorm Hours

Curfew: No Curfew
Breakfast: 6:30AM ~ 8:30AM
Dinner: 6:30PM ~ 11:30PM
Public Bath: 6:30PM ~ 0:00
Private shower: 24hrs available

Access to Ichigaya campus

Funabori Sta.⇒ Ichigaya Sta. ¥267

(16min. by Express of Toei Shinjuku Line)

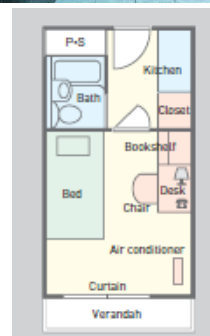

Hosei University Nishi-hachioji Dormitory (For Women & Men)

多摩 TAMA Campus



Access: Approximately 12 min. walk from "Nishi-hachioji Station" of JR Chuo Line

Address: Moto Hongo-cho, Hachioji-shi, Tokyo 192-0051

Room size: 18.00~18.20m² / **Capacity:** 72 people

Dorm Hours

Curfew: No Curfew
Breakfast: 7:00AM ~ 8:30AM
Dinner: 6:00PM ~ 10:00PM
Public Bath: 5:30PM ~ 11:00PM
Private shower: 24hrs available

Access to Tama campus

Nishi-hachioji Sta.⇒ Tama campus

(22min. by bus)

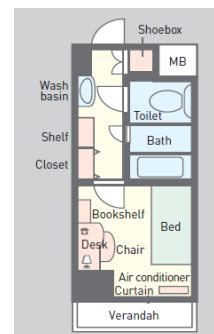

Hosei University Higashi-koganei Dormitory (Only for Men)

小金井 KOGANEI Campus



Access: Approximately 15 min. walk from "Higashi-koganei Station" of JR Chuo Line

Address: Kajino-cho, Koganei-shi, Tokyo 184-0002

Room size: 13.77m² / **Capacity:** 57people

Dorm Hours

Curfew: No Curfew
Breakfast: 7:00AM ~ 8:30AM
Dinner: 6:00PM ~ 10:00PM
Public Bath: 5:30PM ~ 11:00PM
Private shower: 24hrs available

Access to Koganeicampus

Higashi-koganei Sta.⇒ Koganei campus

(8 min. walk)

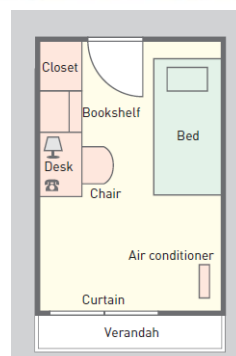

List of charges

Hosei University Funabori Dormitory (For Women & Men)

 市ヶ谷 **ICHIGAYA Campus**



APPLICATION FEE (One Time)	Security Deposit	50,000 yen
	Entrance Fee	150,000 yen (1year) 190,000yen (2years) 250,000yen (3years) 270,000yen (4years)
	Annual Maintenance Fee	224,000yen
	Building Maintenance Fee	3,000yen/year
	Room Cleaning Fee	46,440yen
TOTAL OF APPLICATION FEE		461,440~581,440yen
MONTHLY FEE	Rent	95,100 yen with meals 78,000yen without meals
	Internet Facility Fee	3,888yen
	Electricity Fee	Basic 780yen+ Usage × Tax 8%
TOTAL OF MONTHLY FEE		82,668 or 99,768yen~

Hosei University Nishi-hachioji Dormitory (For Women & Men)

 多摩 **TAMA Campus**



APPLICATION FEE (One Time)	Security Deposit	50,000 yen
	Entrance Fee	180,000 yen (1year) 230,000yen (2 years) 300,000yen (3years) 330,000yen (4years)
	Annual Maintenance Fee	204,000yen
	Building Maintenance Fee	3,000yen/year
	Room Cleaning Fee	46,440yen
TOTAL OF APPLICATION FEE		471,440~621,440yen
MONTHLY FEE	Rent	88,800 yen with meals 71,700yen without meals
	Internet Facility Fee	3,888yen
	Electricity Fee	Direct contract with A power company
TOTAL OF MONTHLY FEE		75,588 or 92688yen~

Hosei University Higashi-koganei Dormitory (Only for Men)

 小金井 **KOGANEI Campus**



APPLICATION FEE (One Time)	Security Deposit	50,000 yen
	Entrance Fee	50,000 yen(1year~4years)
	Building Maintenance Fee	3,000yen/year
	Room Cleaning Fee	35,640yen
	Electricity Fee	66,000yen/year
TOTAL OF APPLICATION FEE		204,640yen
MONTHLY FEE	Rent	66,200 yen with meals (Rent without meals is not available)
	Internet Facility Fee	3,888yen
TOTAL OF MONTHLY FEE		70,088yen

There are
Dormitory for
girls too.

■ Lease Futon(Japanese Bed)・TV・Fridge



<LCD TV>

3 months : ¥11,000
6 months : ¥15,950
12 months : ¥25,300

< Fridge >

3 months : ¥11,000
6 months : ¥14,300
12 months : ¥20,900

<Futon(Bedding set) >



Period	Price
4 months	¥13,200
6 months	¥18,150
8 months	¥21,450
10 months	¥24,750
12 months	¥26,950

※ Bed sheets exchange are provided three times a month.

■ Notice of our pick-up service

• If your flight arrives at Narita airport
between 9:00AM and 3:00PM
from Monday to Friday
except Japanese National holidays,
you can use our pick-up service.

• If your flight arrives other day/airport,
please come to the dormitory by yourself.

■ For those who go to the dorm by themselves

• Check-in time of the dormitory is from 10:00AM to 8:00PM.
Please arrange your transportation to arrive there by 8:00PM.

• You can search the transportation in Japan by this site:
<http://www.hyperdia.com/en/>

■ HOW TO APPLY

SEND US AN E-MAIL

- Please e-mail to int@gakuseikaikan.com giving the following info:
①Your name ②Nationality ③TEL ④Department of Housei University
⑤Month for moving-in ⑥Estimated contract period

SEND US AN APPLICATION

- Kyoritsu Maintenance Co., Ltd. will send you an official application form to your e-mail address. Please read our cancellation policy, and if you agree with it please send it back by e-mail after filling out.

INVOICE WILL BE SENT

- After your qualifications are approved, we will assign your dormitory and send you the result and an invoice. You will be asked to wire the initial cost to our bank account.

INITIAL PAYMENT

- After you pay the initial cost, your contract will be validated officially and cancellation charge is applicable.

MOVE INTO THE DORM

- You move in to your dormitory. Check-in time is from 10:00AM to 8:00PM everyday except Sunday, Japanese national holiday, and dormitory holiday.

SIGN UP THE CONTRACT

- Please participate in a dormitory orientation to sign up the contract.

【Application & Inquiries】

Kyoritsu Maintenance Co., Ltd.

Customer Center, International Dept.

TEL +81-3-5295-7889 Fax: +81-3-5295-5906

E-mail: int@gakuseikaikan.com

